

# \$10,000,000 - 4-24-50-6- Nw, Nisku

MLS® #E4420182

**\$10,000,000**

0 Bedroom, 0.00 Bathroom,  
Single Family on 0.00 Acres

Nisku, Nisku, AB

80 Acres. Located in the Northwest Saunders Lake ASP; Five minute drive to Edmonton International Airport; Adjacent to Leduc city limits and 10 minutes to Leduc core; Parcels can be purchased together or separately; Located south of Nisku Business Park; ; Parcel Size: 80 AC + 160 AC + 160 AC=400 Acres. Zoning: AG (Agriculture). Legal Description: West 80 - 4;24;50;6;NW East 160 - 4; 24;50;6;NE - West 160 - 4;24;50;7;SW. Information herein and auxiliary information subject to becoming outdated in time, change, and/or deemed reliable but not guaranteed.

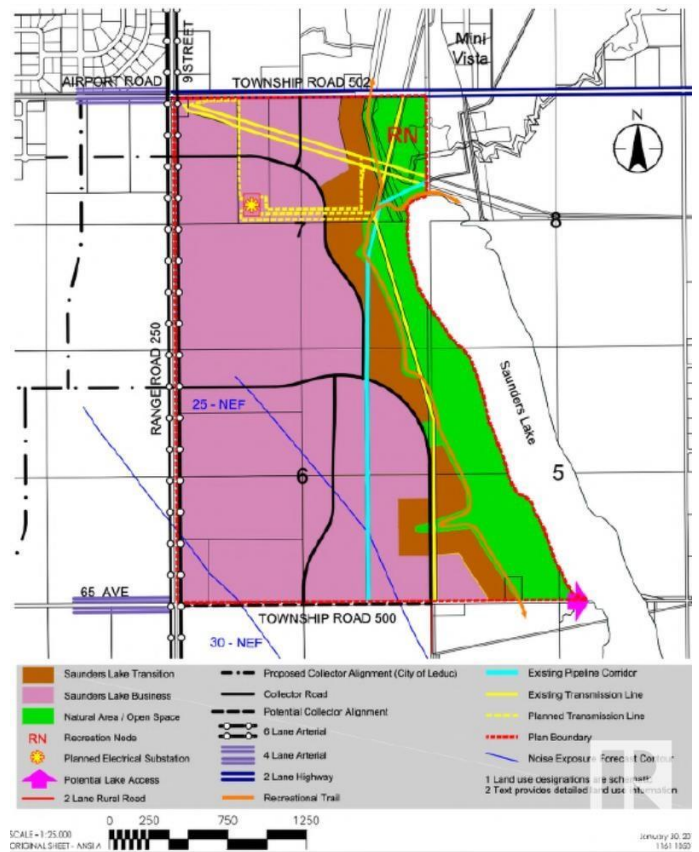

## Essential Information

MLS® #	E4420182
Price	\$10,000,000
Bathrooms	0.00
Acres	0.00
Type	Single Family
Sub-Type	Vacant Lot/Land
Status	Active

## Community Information

Address	4-24-50-6- Nw
Area	Nisku
Subdivision	Nisku
City	Nisku



County ALBERTA  
Province AB  
Postal Code T9E 0A0

## Exterior

Exterior Features See Remarks

## Additional Information

Date Listed February 1st, 2025  
Days on Market 41  
Zoning Zone 81

DATA IS DEEMED RELIABLE BUT IS NOT GUARANTEED ACCURATE BY THE REALTORS® ASSOCIATION OF EDMONTON. COPYRIGHT 2025 BY THE REALTORS® ASSOCIATION OF EDMONTON. ALL RIGHTS RESERVED. Trademarks are owned or controlled by the Canadian Real Estate Association (CREA) and identify real estate professionals who are members of CREA (REALTOR®, REALTORS®) and/or the quality of services they provide (MLS®, Multiple Listing Service®)

Listing information last updated on March 14th, 2025 at 7:32am MDT